

## Screw Pin Standard Bow Shackle

- Grade 6 high tensile steel body and pin, quenched and tempered.
- Meets the W.L.L. requirements of EN 13889 from sizes 0.33 tonne to 25 tonne.
- Meets the W.L.L. requirements of US Fed Spec RR C 271.
- Supplied with an EC declaration of conformity.
- Safety factor 6:1.
- Hot dipped galvanised.
- Marked with manufacturers mark, size, ID mark, CE and W.L.L.

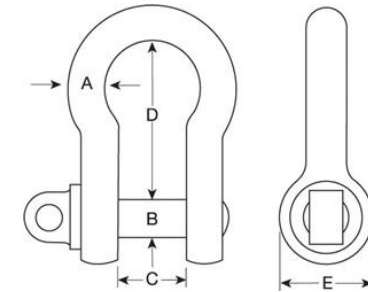

W.L.L	A	B	C	D	E	Weight
(tonnes)	(mm)	(mm)	(mm)	(mm)	(mm)	(kgs/100)
0.33	5	6	9.5	22	16	0.02
0.5	6.4	8	12	28.6	20	0.06
0.75	8	10	13	31	21	0.11
1	9.5	11	17	36.5	26	0.15
1.5	11	12	18	42.5	29	0.21
2	12.7	16	20.6	47.3	32	0.37
3.25	16	19.8	27	60.5	43	0.65
4.75	19	22	32	71.5	51	1.04
6.5	21.7	27	36.6	84	58	1.56
8.5	25.4	30	43	96	68	2.32
9.5	28.5	33	46	108	75	3.28
12	31.5	36	51.6	119	83	4.51
13.5	34.9	39	57	133.5	92	5.93
17	38	42	60	147	99	7.89
25	44	52	73	178	126	13.4
35	50	56	82	197	138	18.85
55	63.5	68	105	267.5	180	37.86

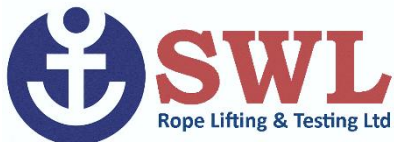

SWL Rope Lifting & Testing, 65-69 Bernard Street, Southampton Hampshire, SO14 3BA

Telephone: 02380 338286

Email: [sales@swl.org.uk](mailto:sales@swl.org.uk)